

CLUEDO



Introduction

Cluedo is a popular murder-mystery themed deduction board game originally published by Waddingtons in Leeds, England in 1949. It was devised by Anthony E. Pratt, a solicitor's clerk and children's entertainer born at 13 Brighton Road, Balsall Heath. It was during the Second World War that Anthony Pratt had the idea for a Murder Mystery Board game. Evenings spent behind wartime



Anthony and his wife Elva in the garden of Stanley Road during the early 1940s around the time he invented Cluedo.

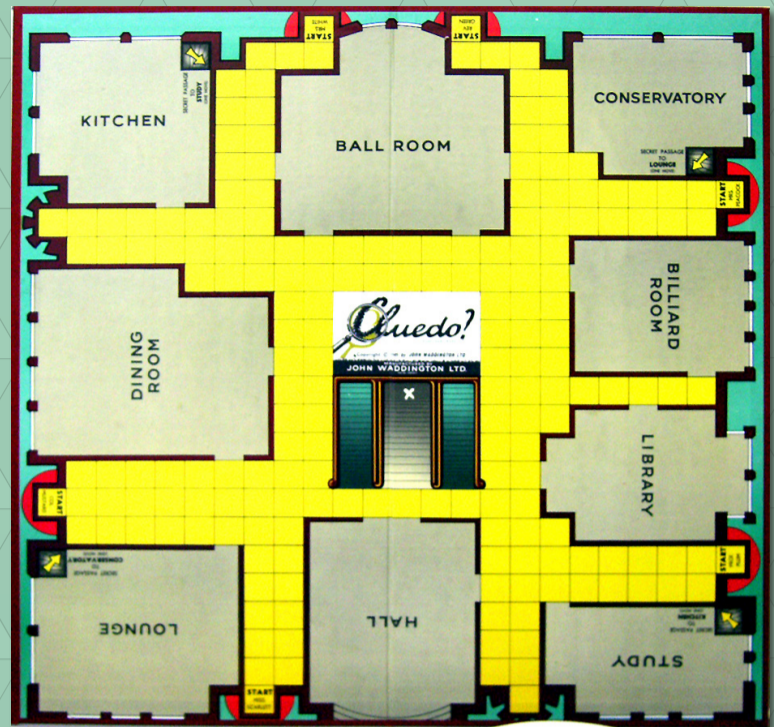

The classic Cluedo board

blackouts were a world away from the pleasant musical evenings and social gathering of friends – it was all such a dampener on people's social lives. The idea for Cluedo came from his days spent playing musical concerts in country hotels where part of the evening's entertainment would have been murder games.

Phil

I always enjoyed playing Cluedo as a lad. There was always an air of mystery about those three cards in the middle of the board.



Supported by

The National Lottery®

through the Heritage Lottery Fund



**Diamond
Balsall Heath**